

SPECIFICATION FOR APPROVAL

Material

Production:	Neu Flux Cores
FUAN.P/N:	KNF157-026A
AL:	35(nH/N ²)±8%
Material:	26 μ
Coating Color:	Brown
Coating material:	epoxy
Coating Breakdown Voltage:	1000V, 0.5mA, 2Sec

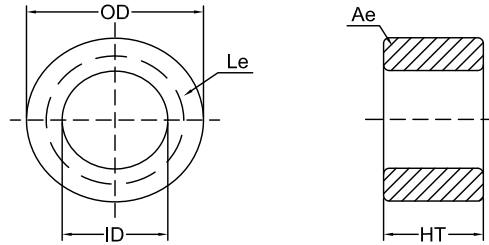

Physical Characteristics

Before Coating			After Coating			Le(cm)	Ae(cm ²)	V(cm ³)	W(cm ²)	Weight (g) (ref.)	Box Quantity (Pieces)
OD(Max.) in/mm	ID(Min.) in/mm	Ht(Max.) in/mm	OD(Max.) mm	ID(Min.) mm	Ht(Max.) mm						
1.571 39.90	0.949 24.10	0.571 14.50	40.72	23.30	15.37	9.840	1.072	10.50	4.262	70.2	150

Electrical Parameters(Typical) Temperature(25°C±2°C)

Test Item	Test Condition	Value(Typical)	Test Instrument
Inductance	φ1.2mm/52Ts, 20kHz/1V, I=0A (Evenly full windings)	94.6μH±8%	CH3302
DC-Bias	φ1.2mm/52Ts, 20kHz/1V, I=45A(H=300Oe) (Evenly full windings)	58.3μH(Min.)	WK3255B+WK3265B
	φ1.2mm/52Ts, 20kHz/1V, I=60A(H=400Oe) (Evenly full windings)	47.9μH(Min.)	
Core Loss	50kHz/1000Gs	750mW/cm ³ (Max.)	SY-8219
Remarks	Set the internal resistance of LCR meter to 100Ω.		

Core Loss Curves(Typical)

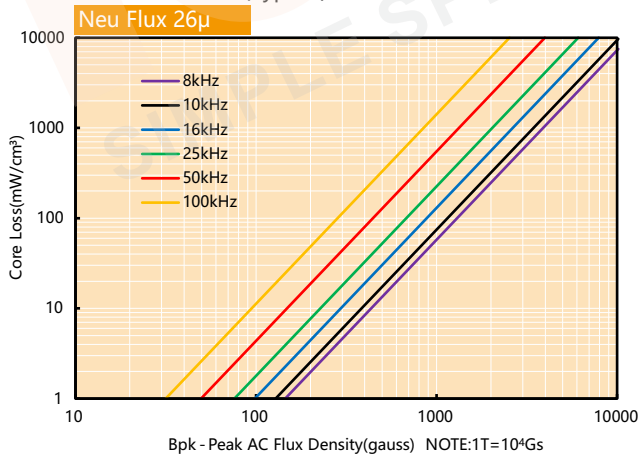

DC- Bias Curves(Typical)

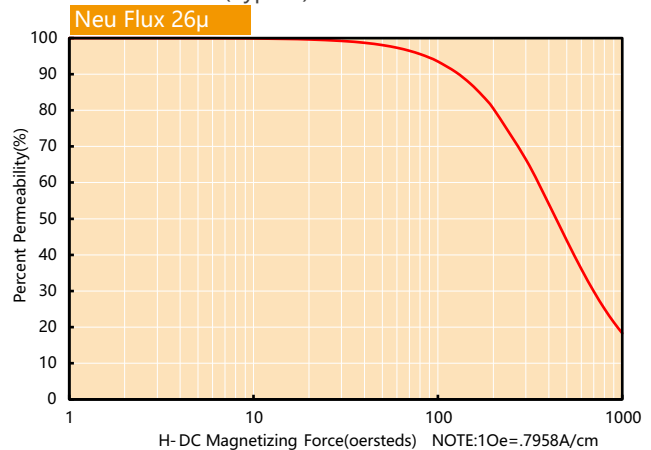

Neu Flux Cores are made of 85% Fe & 15% Si-Ni alloy powder; Its saturation flux density is 16000Gs, permeability is around 26u-90u, the loss is about half of Si-Fe cores, similar to High flux cores, the DC offset performance is better than Si-Fe cores, same as High flux cores, which is a low-cost material can replace High flux cores; Meantime, it is also an ideal substitute for Amorphous powder cores. Moreover, it has excellent temperature stability and high energy storage capacity also solve the noise problem of Amorphous powder cores.